

These drawings and specifications are the property of H2W Technologies, Inc. They are issued in confidence and shall not be reproduced, copied, or used without written permission from H2W Technologies, Inc.

REVISION TABLE					
REV	ECN#	DESCRIPTION	REV BY	APPROVED	DATE
---	---	Original Drawing	OOG	MPW	3-15-13

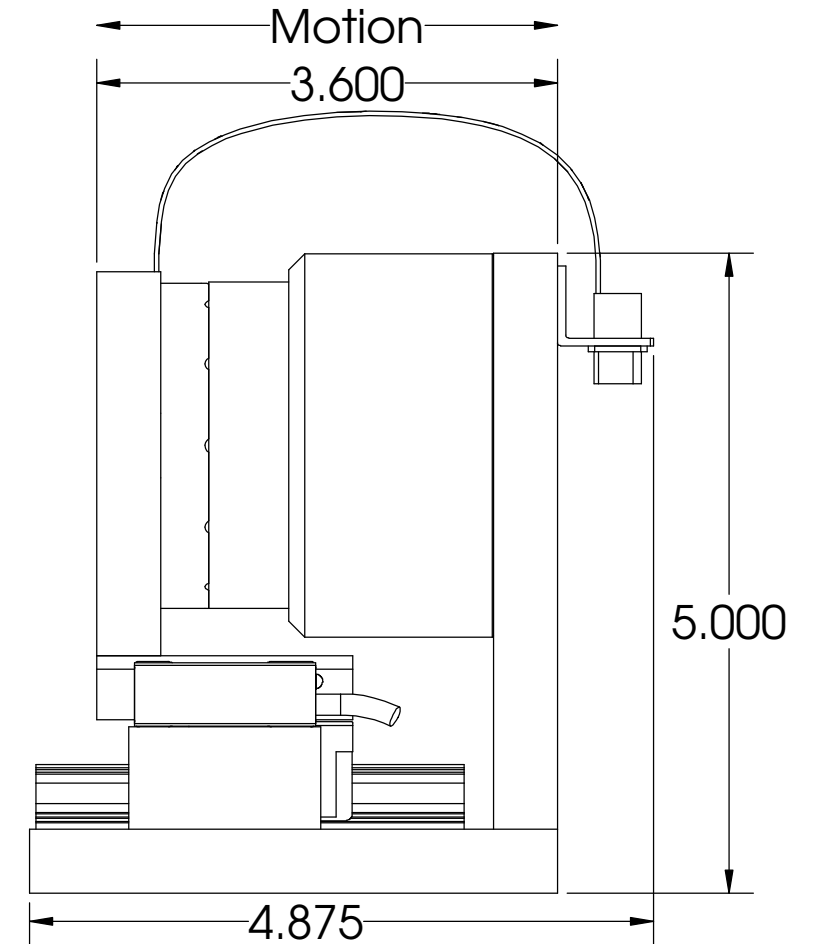
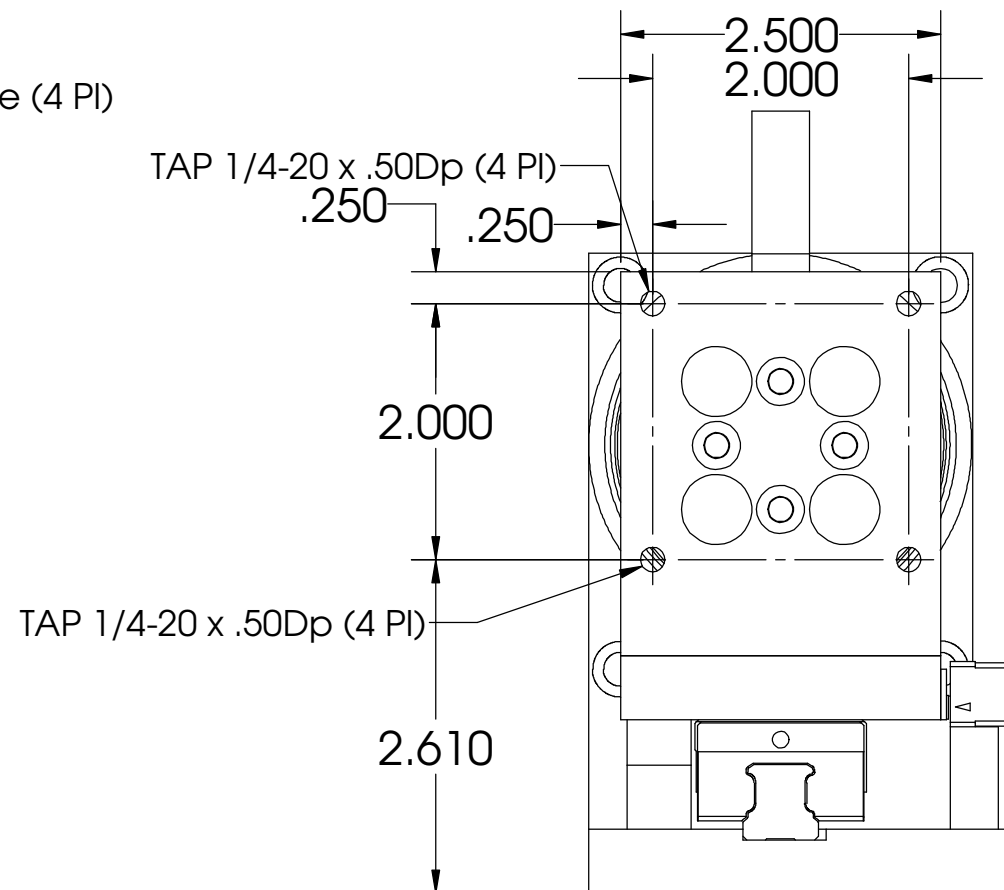
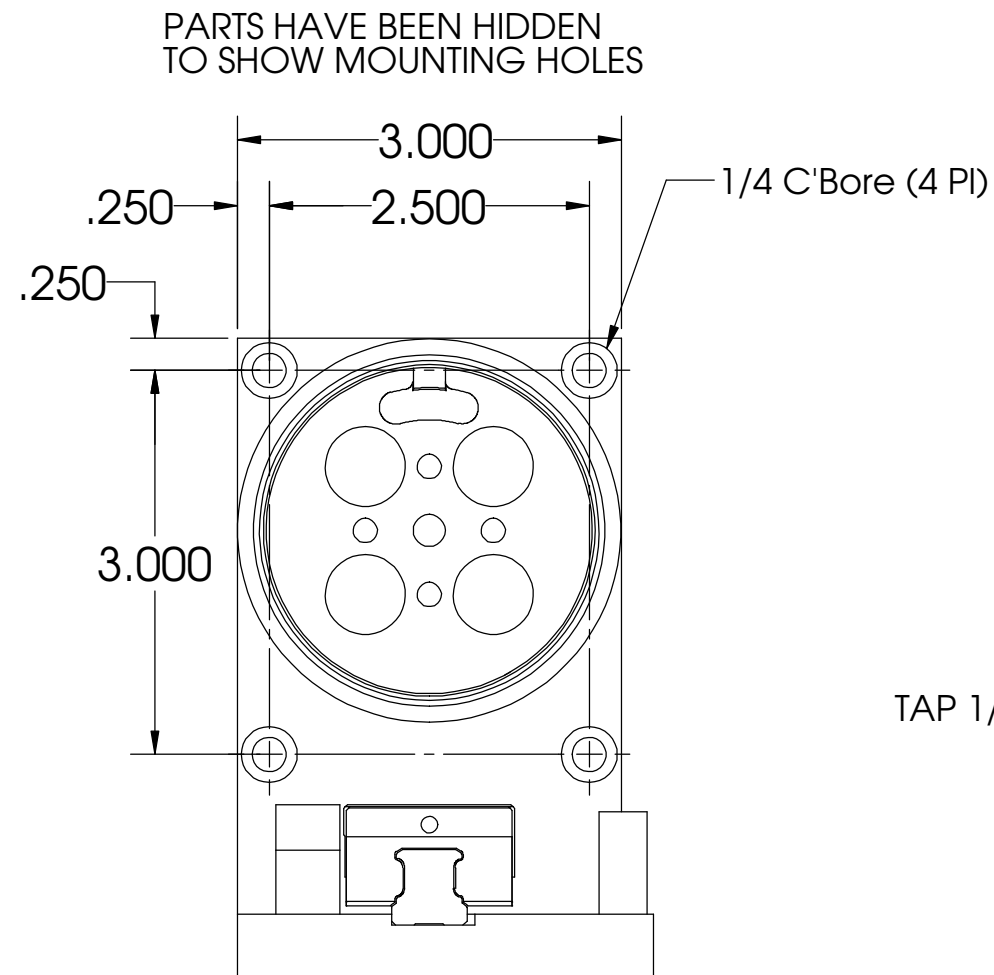
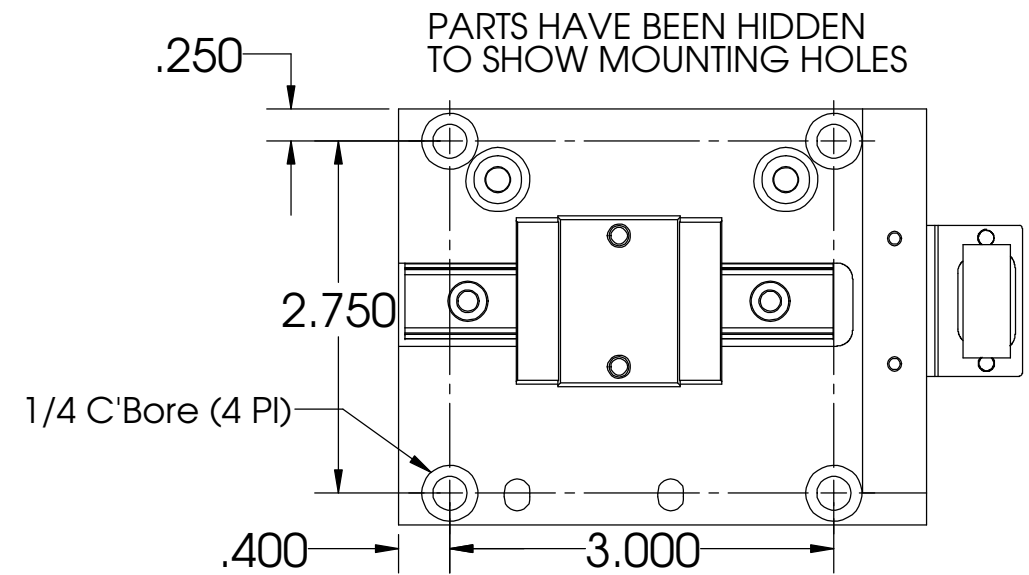

Motor Shown at Mid-Stroke

UNLESS SPECIFIED OTHERWISE:
 All dimensions are in inches
 Standard Tolerances are as follows
 .XXX ±.015 ANGLES ±1°
 .XX ±.010 FILLETS AND
 .X ±.020 CORNERS .010
 Remove All Burrs and Sharp Edges

MATERIAL		FINISH	
DRAWN	DATE	APPROVED	DATE
OOG	3-15-13	MPW	3-15-13

TITLE			
Voice Coil Positioning Stage Model #: VCS13-108-LB-01-MC			
DWG#	REV	SHEET	
31-0613	---	1 of 3	

H2W Technologies, Inc.
 26470 Ruether Ave #102 Santa Clarita, CA 91350 USA
 Tel: (661) 251-2081 Fax: (661) 251-2067
 www.h2wtech.com

These drawings and specifications are the property of H2W Technologies, Inc. They are issued in confidence and shall not be reproduced, copied, or used without written permission from H2W Technologies, Inc.

Horizontal Configuration

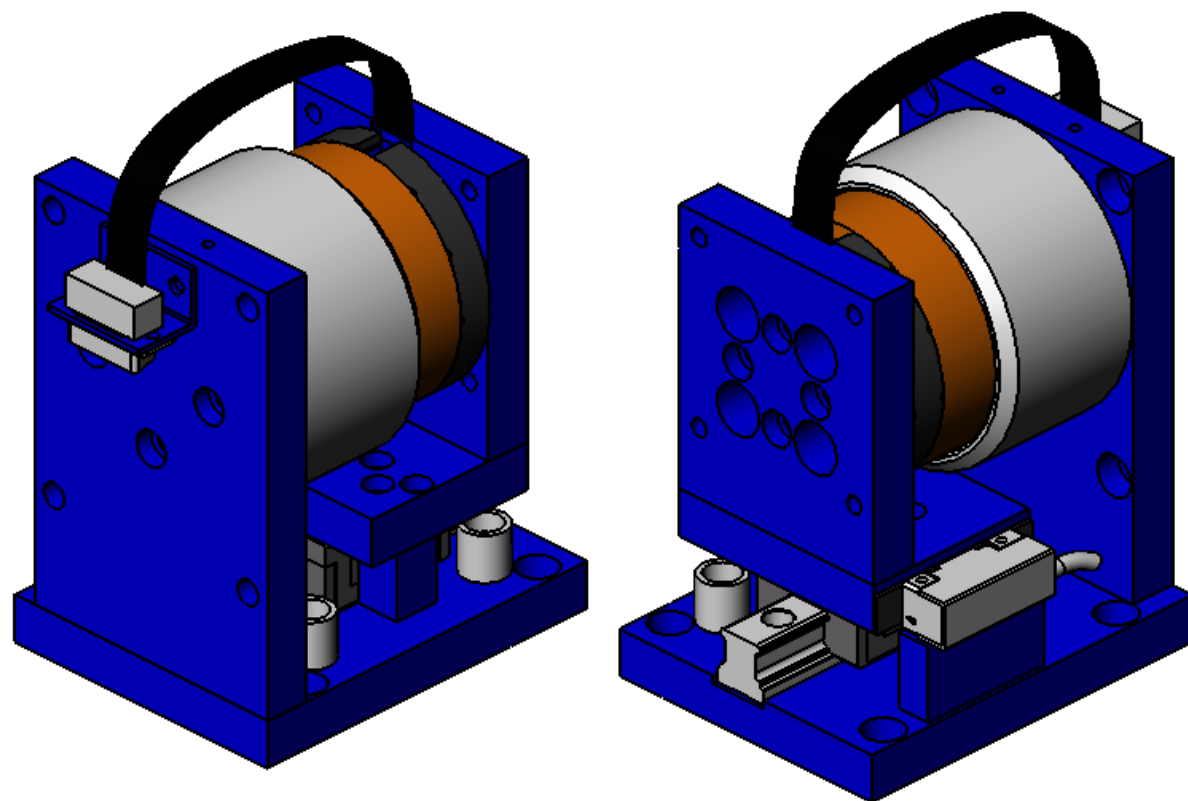

Vertical Configuration

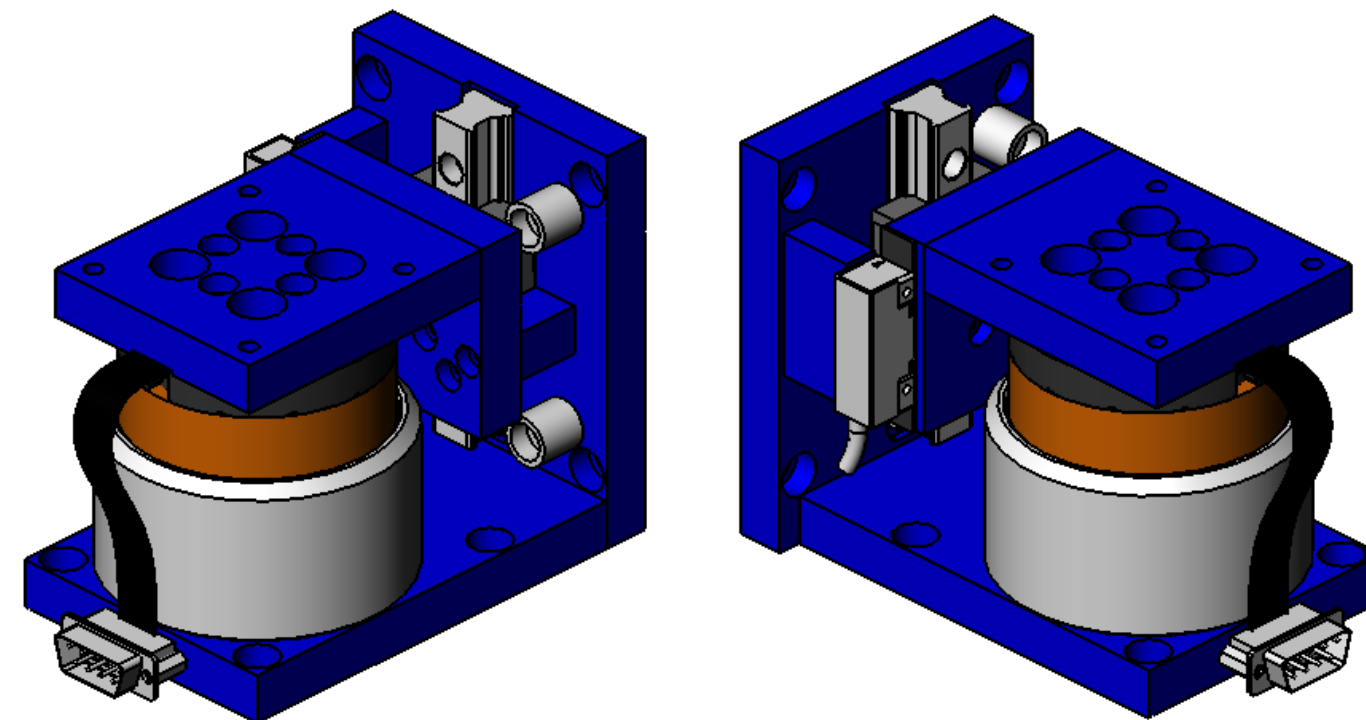

These drawings and specifications are the property of H2W Technologies, Inc. They are issued in confidence and shall not be reproduced, copied, or used without written permission from H2W Technologies, Inc.

MOVING COIL NON-COMM ACTUATOR SPECIFICATIONS		
Motor P/N	NCC13-30-108-1H	
Stroke	1.25"	31.8 mm
Encoder Resolution	1 micron	
Bearing Type	Linear Bearing	
Moving Mass	1.50 lbs	418 grams
Total Mass	6.0 lbs	2.0 Kg
Resistance @ 20C	4.8 ohms	
Inductance @ 20C	4.1 mH	
Electrical Time Constant	0.9 msec	
Motor Constant	2.3 LBS/SQRT(Watt)	7.6 N/SQRT(Watt)
Force Constant	5.0 LBS/Amp	22.3 N/Amp
Back EMF	0.5 V/ips	22.3 V/m/sec
Continuous Force	10.8 LBS	48 N
Max Power @ 100% Duty	23 Watts	
Peak Force	32.4 LBS	144 N
Max Power @ 10% Duty	200 Watts	

